

6'-8" HIGH PARAPET WITH BARRIER CURB

ISSUED: 2009

PLATE
3.7-1

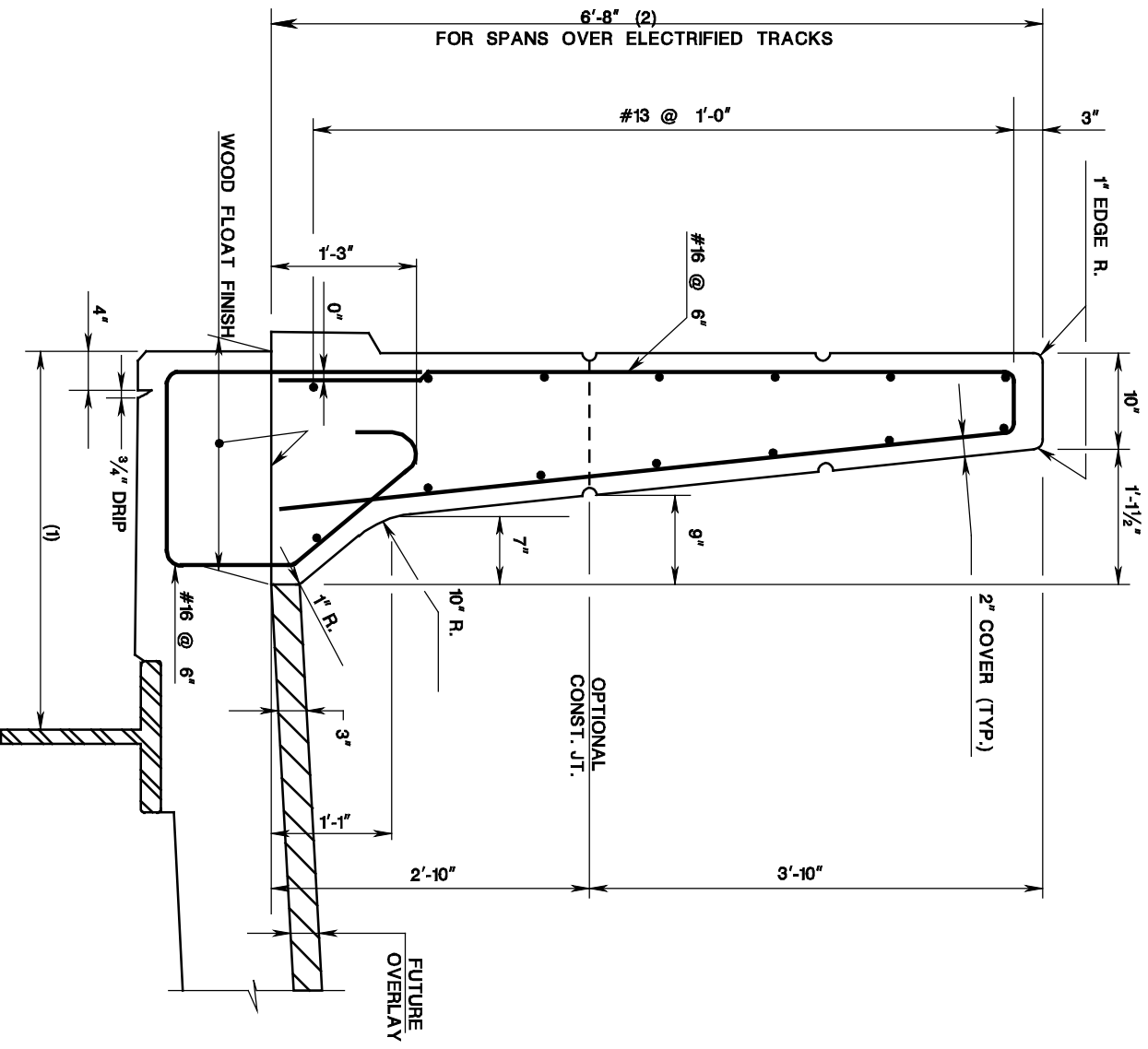

NOTES:

1. PREFERRED MAXIMUM OVERHANG IS 2'-6".
2. FACIA RUSTICATION AND/OR CONFIGURATION SUBJECT TO STUDY AND DEVELOPMENT ON AN INDIVIDUAL BRIDGE BASIS.
3. SEE SUBSECTION 20.12 OF THIS MANUAL FOR LOCATION OF CONTRACTION AND OPEN JOINTS IN PARAPET AND BARRIER CURB.
4. ALL REINFORCING STEEL SHALL BE CORROSION PROTECTED.
5. PROVIDE ADDITIONAL REINFORCEMENT IN THE VICINITY OF PARAPET JOINTS TO PREVENT CRACKING IN THE DECK OVERHANG. REFER TO STANDARD BRIDGE CONSTRUCTION DETAIL.